

1	2	3	4	5	6	7	8				
THIS DRAWING AND THE DATA DISCLOSED HEREIN OR HEREWITH IS NOT TO BE REPRODUCED USED OR DISCLOSED IN WHOLE OR IN PART TO ANYONE WITHOUT THE PERMISSION OF JESS-LINK PRODUCTS CO.,LTD.(JPC)				CUSTOMER DRAWING DRWC-XXXXXX		REV.	ECN NO.	DESCRIPTION	MDF'D	APP'D	DATE
						01		INITIAL DESIGN	Philip	Richard	07/06/2023
						02					
						03					

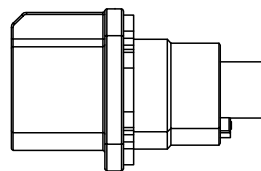
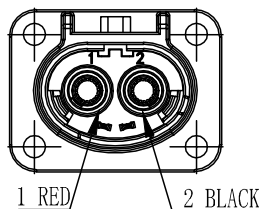
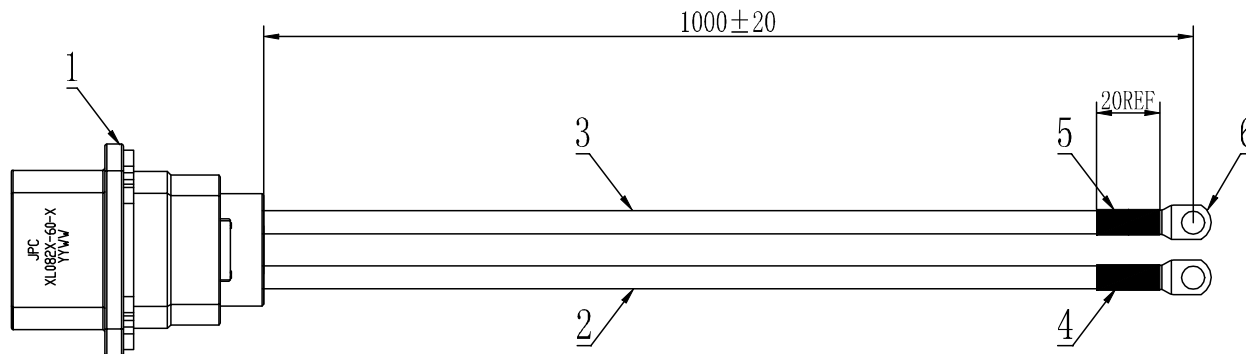

6	Terminal	SC6-8		2
5	HST	H-5(3X)6/2 black	20	1
4	HST	H-5(3X)6/2 RED	20	1
3	Cable	EV-6mm ² unshielded XLPE BLACK		1
2	Cable	EV-6mm ² unshielded XLPE RED		1
1	Connector	XL60 Receptacle		1
序号	名称	规格型号	长度	数量

SPEC:
 1. Insulation material : XLPE;
 2. Rated voltage : 1500V;
 3. Rated Temperature : 125°C;

RoHS COMPLIANT	Unit:mm(inch)	PROJECTION	ZCables.com		
	GENERAL TOLERANCES: (UNLESS SPECIFIED)	D.R. 07/06/2023			PD./FILE NO.
	0 = ±1 (0.039)	Philip	TITLE		
	0.0 = ±.5 (0.02)	CH.K 07/06/2023	XL60 Receptacle To M8 Tongue Terminal , 2X 6mm ² , Orange Cable , L=1M		
0.00 = ±.3 (0.012)	Philip	SCALE	SIZE	PART NO.	REV.
0.000 = ±.15 (0.006)	APV.D 07/06/2023	1:1	A4	PZBDRQ010-0002	01
0° = ± 2'	Richard				SHEET 1 OF 1
0.0° = ± 1'					